

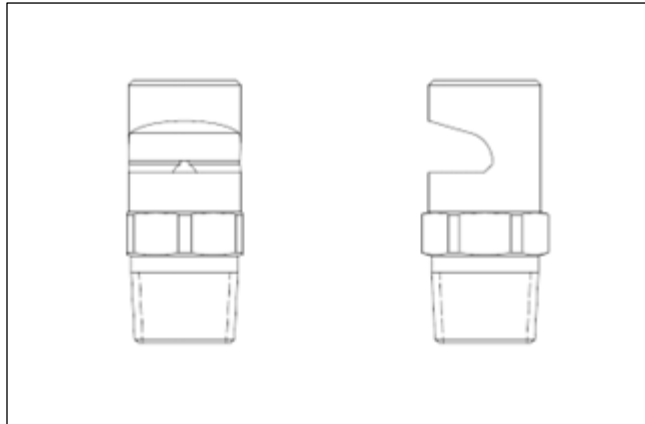

Manufacturing Intelligent Compressed Air Products Since 1983  
 11510 Goldcoast Drive, Cincinnati, OH, USA 45249-1621  
 (513) 671-3322 FAX (513) 671-3363 Email: techhelp@exair.com



## **POWERSTREAM DEFLECTED FAN LIQUID ATOMIZING NOZZLES** **INSTALLATION & MAINTENANCE**



### **LIQUID SUPPLY**

For all products covered in this literature, EXAIR recommends the liquid be filtered with a #100 mesh or finer. Quick connects, elbows and other potential pressure drops should be kept to a minimum. Maximum liquid pressure is 250 PSI (17.2 BAR, 1.72 MPa). EXAIR liquid nozzles are not suitable for use with low flashpoint liquids.

### **USING ATOMIZING NOZZLES**

In most cases, the Atomizing Nozzle can be supported by the liquid supply pipe. Make sure the force generated by the liquid coming out of the nozzle does not move it from the desired position.

### **SAFE OPERATING PRACTICES**

The following is a safety checklist to encourage proper use of PowerStream Nozzles.

1. Inspect all of the components used in the liquid supply system to make sure that all connections (fittings) are tightened properly.
2. Inspect the Liquid Atomizing Nozzle to make sure there is nothing attached to the end that might become a flying projectile.
4. Always wear OSHA approved PPE, such as safety glasses with side shields, when working in close proximity of the spraying operation.
5. Always consider the direction you will be spraying to make sure any loose debris flies in a safe direction.
6. Always depressurize liquid supply line before attaching a Liquid Atomizing Nozzle. Repressurize the line once connected.
7. Never engage in horseplay or point a Liquid Atomizing Nozzle at someone.

### **TROUBLESHOOTING & MAINTENANCE**

**If there is a reduction in flow or force from the Atomizing Nozzle**, check the pressure by installing a gauge at the inlet of the Liquid Atomizing Nozzle. Large pressure drops are possible due to undersized lines, restrictive fittings and clogged filter elements.

**CLEANING**

If contaminants have clogged the Liquid Atomizing Nozzle, inspect the unit by disassembling. Position body securely between the soft jaws of a vise. Use a wrench to unscrew the Cap (counter-clockwise) from the body. Inspect each part for dirt contamination. Clean each part and reassemble. Use a soft bristle brush or toothpick, never anything sharp or abrasive such as a paper clip or knife.

If you have any questions or problems, please contact:

**EPUTEC Drucklufttechnik GmbH**

Haidenbacherstr. 1 | 86916 Kaufering | Germany

Phone: +49 8191 91 51 19 0

Fax: +49 8191 91 51 19 91

Email: [info@eputec.de](mailto:info@eputec.de)

Website: [www.eputec.de](http://www.eputec.de)

